

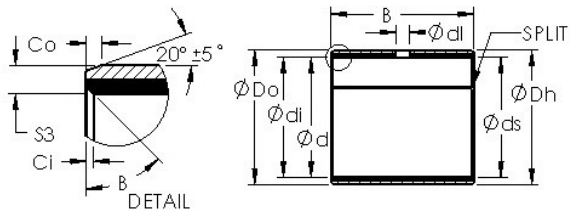

# Seo-NTN Driveshaft USA CORP.



## AST AST50 88IB32 plain bearings

Bearing No. AST50 88IB32

|  |   |
|--|---|
| Bore Diameter                                      | 139,7 mm                                    |
| Bearing Type                                       | straight                                    |
| Shaft Dia., Nominal (d)                            | 5.5000                                      |
| Shaft Size (ds) - 5.5                              | 5.4975                                      |
| Housing Bore Dia. (Dh) - 5.6874                    | 5.6858                                      |
| Bearing Bore after Mounting (di) - 5.507           | 5.5002                                      |
| Average Clearance (Cd)                             | 0.0048                                      |
| Wall Thickness (S3)                                | 0.095                                       |
| Bearing Length, Nominal (B)                        | 2.000                                       |
| Bearing Length Tolerance (B tol.) - +.010 / -0.010 | +.010 / 0.010                               |
| OD Chamfer Length (Co)                             | 0.072                                       |
| ID Chamfer Angle (B deg.)                          | 30  |
| ID Chamfer Length (Ci)                             | 0.031                                       |
| Material   | Carbon steel shell with PTFE / Fiber lining |

AST50 88IB32 Bearing 2D drawings and 3D CAD models